



Caddy Box

⚠ WARNING 	ELECTRICAL SHOCK HAZARD Disconnect power before installing or servicing this product. A qualified service person must install and service this product according to applicable electrical and plumbing codes.	⚠ WARNING 	EXPLOSION OR FIRE HAZARD Do not use this product with flammable liquids. Do not install in hazardous locations as defined by National Electrical Code, ANSI/NFPA 70.
---	---	---	--

1. Observe National Electric Code, ANSI/NFPA 70, when installing this unit to prevent moisture buildup. SPI is not responsible for damage or injury resulting from improper installation procedure.
2. Turn off power. Drill a 2-3/8" hole in the basin or tank riser for a 2" conduit fitting. Attach the caddy box to the basin or tank riser using standard plumbing fittings and seals. With PVC solvent, weld the conduit into the junction box adapter that is factory installed.
3. Optionally, or if it is supplied, mount a 3/4" PVC fitting for bringing in pump and alarm power wires. Again, use standard plumbing fittings and seals to attach the 3/4" conduit. Seal the 3/4" terminal adapter with a conduit sealing compound.
4. Strip power wires and alarm cords as shown in figure 3. Follow the connection diagram shown inside the caddy box. Two terminal blocks will be for the incoming pump power supply. The other two may be used to join an alarm float to remote alarm panels. **NOTE:** Remote alarm panel not included. Consider ordering a 10A100, 10A200, or 10A500 alarm separately. Alternatively, consider a 10A650 which includes an alarm circuit.
5. String the pump plug, float plug, and alarm float through the 2" conduit. Insert the circular rubber seal with cords positioned in the openings of the seal and washers. If you only need one float, use the included plugs to seal the unused cord position. Strip the high water alarm float as shown in figure 2. Connect it to the terminal block.
6. If you are using a "piggyback" pump float switch, plug the float switch into the pump power receptacle. The pump should then plug into the float switch. If the float switch is built into the pump, you may simply plug in the pump.
7. Secure the caddy box lid
8. Turn on power and test the alarm by tilting the alarm float switch. The buzzer and alarm light should switch on. If it does not, try the test button. If the alarm is still not functioning, contact your sales representative or SPI.
9. Test the pump by tilting the pump float. The pump should switch on.



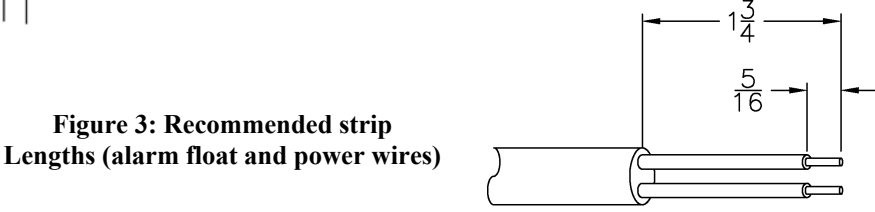
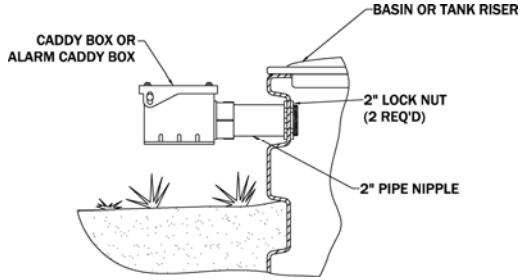
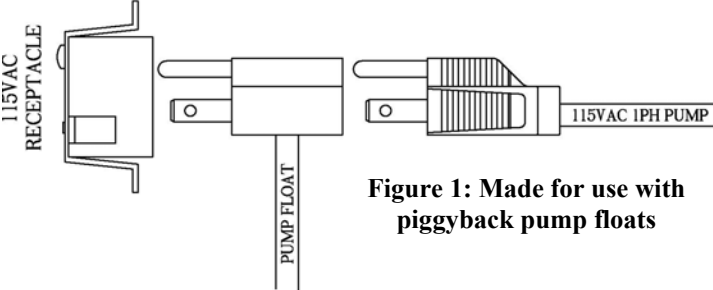

Junction Boxes

Caddy Box

Features & Benefits

- Durable NEMA 4x Thermoplastic Enclosure
- Built in Receptacle (115VAC or 230VAC)
- Removable Inner Bracket
- Terminal Block for Incoming Power and Remote Alarm Connection
- PVC Mounting Hardware
- Easily Mounted to Tank Riser
- Suitable for Indoor or Outdoor Use
- Several Options Available

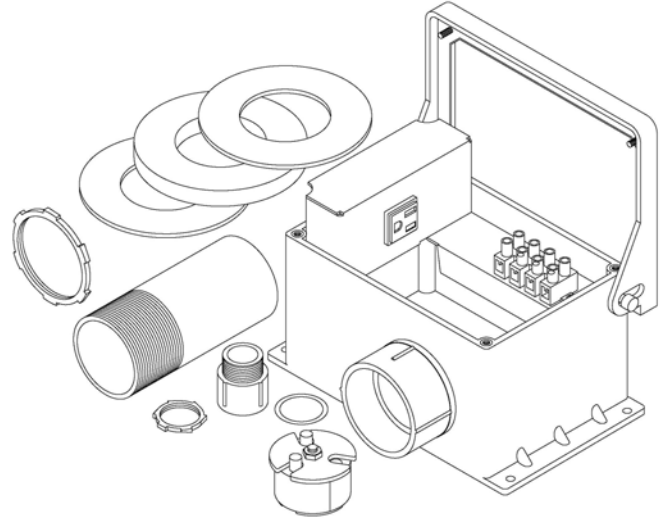

(Standard 10A600 Caddy Box Shown)

Typical Dimensions

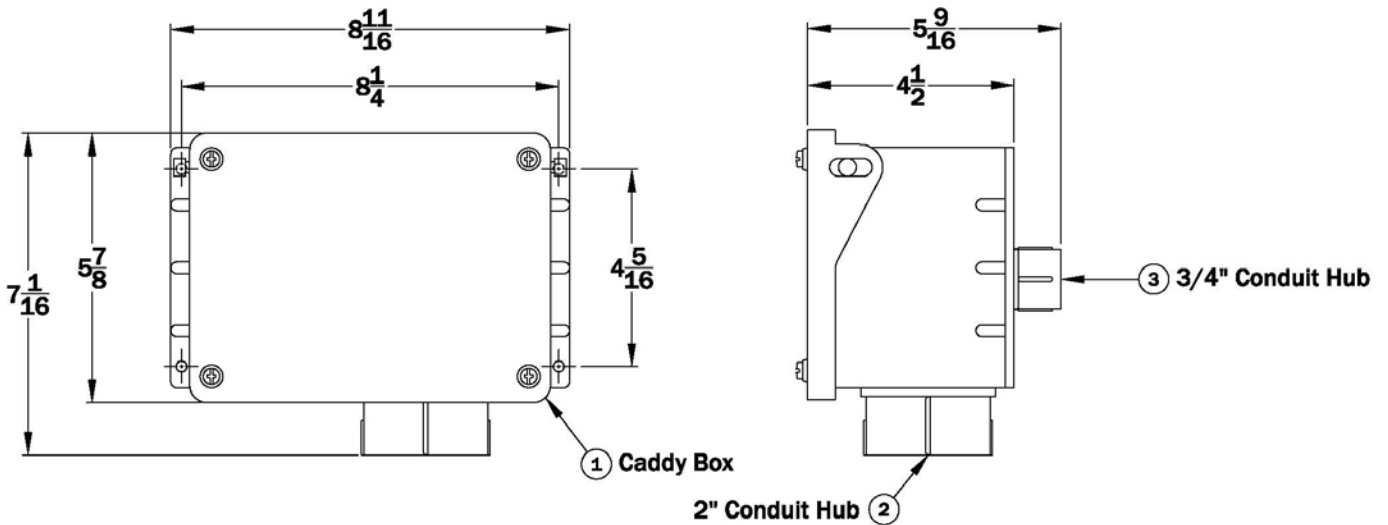

*Note: Consult the factory for other available options.